

News and Notes

For Bodenham, Britford, Charlton All Saints, Nunton and Odstock

March 2021

In this issue:

Pages 1 - 4
News

Page 5
Longford
School

Pages 6 - 9
Adverts

Page 10 - 11
A point of View

Page 12
Church News

Page 13+
e-News

Editor:
Jeremy
Metcalf

Email:
editor@
newsandnotes.co.uk

Web page:
[Newsand
Notes.co.uk](http://NewsandNotes.co.uk)

**Next
Deadline:**
**14 April
2021**

Hunger

This time of the year is traditionally the “hunger season”: the harvests from last year eaten and awaiting the first crops of the new season. The way the birds attack the birdfeeders still gives a hint of this. Traditionally for the church it is a season of fasting before the Easter feasting. This year this time feels very much like a “hunger season” not hungry for food but hungry for social proximity. I am hungry to be with people, lots of people in a small space. Instead we are still social distancing hoping that the end is near and soon the party may start again. So this time offers us the opportunity to sit and reflect and hunger for God. And that is something to be thankful for as well. Not everybody can easily sit. The school in Cueibet has hardly any furniture. Benches are carried from church or children sit on the ground. There is a hunger for learning but the basics are missing. This Lent we hope to support them to be able to buy school benches and desks. Maybe we could sponsor a certain amount for every chair in our house, while we sit and reflect on our own longings.

As a deer longs for flowing streams, so my soul longs for you, O God.
Ps. 42: 1

Shalom - peace and goodwill, The Reverend Anna-Claar

Hope

Hope has been on my mind for the last few weeks, and hope runs through this edition. There is hope that the schools will soon open. Read about schooling at Longford school and a working mum home schooling two children.

Many have been vaccinated. Hope that we will soon be able to meet up with friends and family.

Alas, we are unable to meet for our Lent project events, but we can support Cueibet school children by donating towards their desks and chairs. The South Sundanese have hope, because they know that they have not been forgotten by us. Please support this project.

I would draw your attention to the plans to build two large housing estates near the Britford Park and Ride. We can only hope that the right decisions will be made. Details of the scheme and how to comment are available to read, and more details in the e-N&N version.

In hope for a brighter summer.

Jeremy Metcalfe - Editor

Odstock Parish Council

ONB Parish Council Update

The Parish Council met on Monday 8 February 2021 via a video-conference.

New footpath

We have now received the final plans and costings for the proposed new tarmac footpath running from Nunton Farm to Stoney Close. We have applied for funding, and if our application is successful, we hope that the work will be done in 2021.

Nunton playground

It is good to see that the new playground is in frequent use. We hope that the new fence will be installed during the last week in February. Two picnic benches will be installed later.

Parish council elections

The government has confirmed that local elections, including parish council elections, will go ahead on 6 May 2021. All the seats on Odstock Parish Council (OPC) will be up for election, and anyone on the electoral roll can stand for election as long as they are resident within, or own property within the parish boundaries. Not all of the current parish councillors will be standing for re-election, so please do consider whether this is a role that you could take on. The OPC normally meets five times a year on a weekday evening. The meetings are held in public, and last around 90 minutes. The role of the Parish Council is to represent the views of people living in the parish on matters affecting our villages, and to make decisions about the upkeep and improvement of parish amenities. Any of the existing OPC councillors will be happy to talk to you about the role if you are interested. The Good Councillors Guide, published by the National Association of Local Councils (NALC), can be downloaded from the OPC website at www.odstock.info.

Speed Indicator Device (SID)

Sherwood Elcock, the leader of the Community Speed Watch Team, has investigated the options for installing a portable Speed Indicator Device at key points on the road through Odstock and Nunton. Sherwood presented his report, summarising the main issues, and has kindly offered to do further work on this project for discussion at the next OPC meeting.

Parish pickers

The amount of litter in the verges around the parish has become an issue, and some noble, public-spirited residents have been seen out with bags collecting it up. (You know who you are, and thank you!). It has been suggested that the parish should have its own community litter-picking team. If enough people are interested in being involved the parish council will look into buying the proper litter-picking equipment and high-viz tabards. Would you be willing to spare the occasional half hour to help keep our villages clean and tidy? If so, please contact [Sally Nelson](#) on 01722 328220.

Date of next meeting

The next OPC meeting will be held via video on Monday 19 April at 7.30 pm. Please let us know in advance if you would like to attend.

Britford Parish Council

Housing development sites in Britford

Wiltshire Council Local Plan Review Consultations

Wiltshire Council are undertaking a review of the local plan and are proposing to allocate sites for development in Britford. **You should have your say as these proposals will affect your future in all our villages.**

Two of their selected sites are:

- **Site 6 North of Downton Road**

This is the field that separates the village of Britford from the edge of the City Centre. The proposed allocation is for approximately 220 new homes.

- **Site 7 South of Downton Road**

The proposal is for approximately 115 new homes and a green space, potentially in the form of a Country Park.

Wiltshire Council are inviting comments by 9th March 2021.

The following link will give you access to information on:

Planning for Salisbury report and the Site Selection Report for Salisbury

www.wiltshire.gov.uk/planning-policy-local-plan-review-consultation

Britford Parish Council urge you to look at the proposed developments and participate in the consultations, they will be distributing leaflets to residents in Britford with more information. The proposals will have serious consequences for the whole village including Britford Lane, water meadows and villages further downstream. These include flooding and traffic congestion along Downton Road and Harnham. The likelihood of Britford merging into Salisbury City Centre is a real threat, therefore we ask you to please make your views known.

You can email your comments to spatialplanning@wiltshire.gov.uk or post to:
Spatial Planning, Wiltshire Council, County Hall, Trowbridge, BA14 8JQ.

For further information, please contact the Clerk at clerk@britfordparishcouncil.co.uk.

PLEASE HAVE YOUR SAY!
This includes ONB and CAS residents

See e-News&Notes for copy of the Parish Council leaflet

Community News



Mothering Sunday Posies

Mothering Sunday is traditionally a day when families would break the penitentiary period of Lent and meet up together to bring flowers to their Mother or Mother Church. 'They would gather flowers from the hedgerows.' In our church's, we have always made little posies and given them out at the service on Mothering Sunday and any extras left over we would deliver to the housebound.

This year because of the pandemic, we are all housebound and we are not holding services in our Churches of Odstock, Nunton, and Charlton, but we would still like to make posies and deliver them to people's doorstep or window sills.

Would you like to help? Do you know someone that would enjoy receiving a Posie?

Please let us know: Mary Boydcamps 01722 329712 for Odstock, Debby Underhill 01722 329769 for Nunton and Bodenham, and Barbara Box 01725 510758 for Charlton.

Look out for surprise posies on or around the 14th March.



UNIQUE RESIDENCE WITH POTENTIAL

Offer in region of £000,000. For small agents and smaller occupants.

Unfurnished comprising 2 beds, 2 reception, kitchen, hall and stairway. Base 83 x 50 cm; Height including chimney 88cm.

Mid 20th Century, unoccupied for 20 years, the house is in need of restoration- perhaps a lockdown project for an enthusiast in miniature buildings. The house is destined for the bonfire if not adopted. Contact Hatty Hillier on 01722 324788.

Oak Tree looking for a new garden



I have a sturdy young Oak Tree who would like to find a forever home in someone's garden. It has been living in a large pot but would benefit from being allowed to spread its' roots.

Possibly, it could go to live in a "reforesting scheme" It is entirely free to a good home, but I do not have any transport so if you are interested you will need to have a roomy boot or adaptable vehicle or trailer perhaps. To view this poor orphan please phone Mrs Marian Hearne at The Orchard, Nunton. 01722 335685

Odstock, Nunton and Bodenham WI

The ONB WI, like everything else, is in a state of flux as it is not known when Covid19 restrictions will ease or when meetings in the Radnor Hall can start.

Most members have had their first vaccine - variously in the City Hall, Salisbury Cathedral. For those in the cathedral, the organ playing familiar tunes such as 'Oh I do like to be beside the seaside' and 'Hey Jude' was much appreciated.

It was sad to lose a valued member, Louise Jeffreys, who will be remembered for her expertise in gardening, her commitment to WI theatre outings, and for enthusiastically 'having a go'.

The Wiltshire and National Federations of the WI are being active behind the scenes with monthly newsletters and zoom events. Committee meetings are not possible yet but ONB WI members enjoy a monthly Round Robin, thanks to Rose Stephens, and all are now keen to welcome the Spring and the idea of being together again.

Longford Primary School

They say that good things come in small packages and this is true of Longford School; it is a great little primary school. I am so proud to be part of it, especially at this moment in time, as we are faced with unprecedented challenges.

The school community is strong and most caring. Our families come from all walks of life, many of our parents being key workers, including many brave hospital staff or carers - yes, as far as I am concerned, they are brave. One mum, in the red zone, keeps buying us treats and fruit for the children, but in reality, we owe so much to her! We get heart-warming messages from parents and grandparents; they themselves juggling with work and home schooling. As a school, we have also been trying to help others. The children held a collection for Alabaré and Encircle at Christmas, and they have just sent some wonderful snowdrop and bluebell poems to a local nursing home. Our parents all want their children to flourish, to be nurtured as individuals not as statistics, and we know that they appreciate the small class sizes and the welcoming family ethos of the school.

This has been a strange time for schools. Normally, we have time to implement planned government changes; at the moment we are leading change, with government guidance following later: an example of this is food vouchers. My main priority has been to keep the adults and children safe. We have taken swift action and put appropriate measures in place from the start. We are working in class bubbles, with each class having their own entrance door and temperature checks, their playtimes and lunchtimes are staggered. Staff are wearing face masks and complete twice weekly lateral flow tests. As you would expect, there is much handwashing and additional cleaning; this is all set out in copious risk assessments. In addition, there is a good communication network, with teachers contacting parents by phone for a catchup regarding learning and to check all is well.

Children are learning at school and at home. We have been open throughout the lockdowns. We set up 'Google classroom' last summer and it has been a great success, with learning set out for each day, including lesson links and documents. We are providing a daily live lesson for the children at home. Some parents prefer the physical learning packs, sent out regularly to each child. The Friday highlight is a live dance session with Panthera, a local dance company. The children have also enjoyed recorded stories from Revd Anna-Claar Thomasson-Rosingh.

My teachers have been amazing. Teaching a class of children is very different to teaching on line. Not the same at all! Staff have been creative, sending home things like phonics packs and electricity resource packs, to support the live remote sessions, guiding parents and children regarding software and setting out ground rules for learning. I am happy to sing the praises of my teachers all day long, as they are endlessly flexible and enthusiastic! I am also grateful to the wonderful Governing Body, who tirelessly meet up online, giving support and wise counsel, bringing useful experience from their work sectors.

We are looking forward to the day when things can return to normal. I am particularly looking forward to community events and being able to invite you into school. We are here to serve your community and we welcome your friendship and support. For now, please keep safe and take care.

Best wishes,

Louise Knipe, Headteacher at Longford Primary School

Adverts

Britford Farm Shop

Britford Farm Shop is now open.

Booking on 01722 413 400 is advised to avoid disappointment.

We look forward to seeing you for morning coffee or lunch.

Robert Lewis and team

Please support our advertisers, many who live in our area and really appreciate our support.

Aerial drone photography for your home or property.

Crisp and clear photos of your property and land sent to you digitally by an experienced and conscientious person.

A series of up to 20 photos is £30, and a Video is £10.

Drone flyer is registered and licensed, and will only take photos with the land/property owners permission.

**Please call for information and advice
01722 332 727 or 07535 450 052.**

**DON'T stand for a broken chair
when you can sit on a decent
seat**

CHAIRS RE-CANED

Les Dodd 01722 329341



Financial Planning Savings Pensions Investments



- Making sense of your money.
- Preparing realistic and achievable financial plans.
- Working with you to realise your financial future.

Call Ellie Price on 01722 632456 to arrange a friendly, free initial consultation.

ellie@grovelyfinancial.co.uk

www.grovelyfinancial.co.uk

Grovely Financial Limited is an Appointed Representative of Vision Independent Financial Planning Ltd which is Authorised and Regulated by the Financial Conduct Authority.

Local advertisers

Can you fill this space?

The Editor would love to hear from you if you would like advertise within News & Notes. Please make contact via our email address

Radnor Hall update

The Radnor Hall will be open after the lockdown, if current guidelines allow it.

Please email: radnorhallbookings@gmail.com and discuss your booking with Anna, our Hall Manager.

Kevin Knight Clock & Watch Repairs

Free estimates given
Over 30 years' experience

Tel 01722 331969 Mob 07900 928451

Email: kevindavidknight@gmail.com



PC & Laptop Diagnosis & Repair

- Problems with your computer?
- Need something set up on your computer, tablet or phone?
- Or just want to learn how to use them?

Friendly and convenient home visits by a female IT professional.

Email, phone or contact me via the website.

Website: www.itangelsalisbury.com
Email: pippa@itangelsalisbury.com

Phone: 07855 115041



Pure and Exquisite

Nails by Kimberley Creative Nail Design Salon

Acrylic Nail Extensions, Shellac Gel Polish, Luxury & Express Spa Manicures, Luxury & Express Marine Spa Pedicures, Eyelash & Eyebrow Tinting, Eyebrow Shaping, Facial Waxing, Beautiful Pamper Gift Sets available to purchase.

Check out our website for monthly special offers

Phone: 07585 905 905

Email: info@pureandexquisite.co.uk
www.pureandexquisite.co.uk

3 Clearbury Close, Odstock, SP5 4NX

Home baking?



You'd better come and see us, a great flower flour selection when you yeast expect it, for not a lot of dough. Don't delay, you knead to use your loaf and visit us today!

ALSO, DON'T FORGET:

- Contact-free delivery service
- Free delivery within 5 miles of Coombe Bissett
- Low £20 minimum order for free delivery
- No fighting for delivery slots!
- Collect during opening hours if you prefer
- Mail orders to shop@coombebissettstores.co.uk
OR CALL US on 01722 781852

01722 718852

Coombe Bissett Stores • Homington Road
Coombe Bissett SP5 4LR

Shop and Post Office hours
Monday to Friday 7.00 am – 6.00 pm
Saturday 7.00 am – 1.00 pm

Closed Sundays and Bank Holiday Mondays



STABE LTD

Develop | Protect | Innovate | Assure

The GDPR & Data Protection Experts

At STABE we are able to provide a complete data protection service to fit your needs.

Visit www.stabeltd.co.uk or email enquiries@stabeltd.co.uk for more information.

We genuinely believe that good data protection can minimise your organisations risks and we offer GDPR Support, Governance and Compliance, Risk and Incident Management, Data Security Training and DPO Services.

Join the e-News and Notes mailing list

It is very easy to do, just go to NewsandNotes.co.uk website and you will find a link on the front page.

Once a month you will then receive an electronic version of this newsletter, with links to more information than is possible in a printed version.

Cam's Cab

Executive Private Hire,

Air/Sea Transfers

Long Distance and Local Area

Cameron Purdon

07967 724533

ecam62@gmail.com

Professional, Reliable & Courteous

You're in Safe Hands



Steeple Sweeps

Fireplaces, Chimneys, Woodburners
and Stoves professionally swept

Rotary Power and Traditional brushes

APICS trained - Fully insured

Clean friendly service

Certificates issued

Call Steve on 01794 885709

steeplesweeps@gmail.com

HILLSIDE B&B

Odstock Village

Luxury log cabin sleeps up to 5

Plus Twin, Double and Single self-contained rooms

All rooms and the log cabin opening
out on to delightful gardens and
each has a small kitchen with a
fridge and microwave and a light
breakfast included – parking

**Please phone Carol or Jeff
for bookings**

On 01722 329746 or book online at
Hillsidebandb.co.uk

The Yew Tree inn is nearby for great
evening meals

JD Sewing Services

Curtains, Roman Blinds, Cushion Covers

Made for you in your choice of fabrics

Clothing alterations undertaken

No job too small

Contact Jan

01722 334509 or 07810 516221

Plumbing and Drainage Services

- ⇒ 30 Years Experience
- ⇒ Bathroom & Shower installation
- ⇒ Hot water & heating systems
- ⇒ Burst pipes, blocked drains/toilets/sinks
- ⇒ Maintenance & Repairs

Please call David Miller on
01725 512 645 or 07818 046 222
DaveMiller1960@btinternet.com

JANICE'S IRONING

Downton

Ease your life,
Let me do your
ironing !!

£12 per hour

TEL 07879 882348



LIAM BOWEN

Painter and Decorator

**Free Estimates Competitive
Rates**

Phone 01722 334879

Mobile 07712 284618

City and Guilds Qualified

BREAD FLOWERS AT HOME

FRESHLY COOKED TAKEAWAY DISHES DESIGNED TO BE A WEEKEND TREAT

Bread and Flowers brings dynamic, heady flavours that galvanise and inspire.

Dishes are cooked & prepared to order at our HQ.

Ready to be collected by you & reheated at home.

ORDER YOUR TAKEAWAY ONLINE FOR COLLECTION ON FRIDAY 2-6PM

Our Friday menu features

- Mezze / Starters
- Main courses
- Side dishes
- Puddings
- Food for entertaining
- Frozen meals

enquiries@breadandflowers.co.uk

01722 326 581

Bread and Flowers

Longford Farmhouse

Bodenham, Salisbury, SP5 4EJ

breadandflowersathome.co.uk

Handy Man

Friendly & reliable service

All jobs considered including:

Hedge & Grass cutting & Plumbing
Rubbish & Garden clearance & Repairs
Gutters cleaned & repaired & Fencing
Flat pack assembly & Small removals
Fully Insured, No Call Out Fee, No job too small

Call Andy on 07704578293

Email: acnservices@outlook.com

S J GILLINGHAM

Oil Heating Services

Installation - Maintenance - Service

Email : sjgillingham@btinternet.com

Tel 07831 378803



Oil fired boiler maintenance

OFTEC REG OIL ENGINEERS

The Great Outpaws

offers dog walking, home visits, pet taxi and equine services. I am fully insured, DBS checked, canine first aid certified and have a purpose built fully air conditioned and ventilated vehicle to ensure the comfort and safety of your pets.

Please phone 07709291485 or email

TheGreatOutpaws@hotmail.com

with any questions or requests.

BLS

Garden Maintenance Services

- ◇ Lawn Cutting
- ◇ Hedge Cutting
- ◇ Garden Tidy
- ◇ Pruning
- ◇ Contract & One Off

Contact Brett Lyons on
07747 738340

Home Schooling

An insight into home schooling

Ok so when I think about it, it's really not as bad as it was last lockdown, in fact it's blinking amazing what some schools are managing to do. Awe inspiring actually and it makes you wonder how much longer the teachers will manage it. They must be exhausted. I am and in the main I am just supervising, not actually teaching. I have witnessed the success of lessons in long multiplications via zoom for the 10 year old, poetry lessons that made me wish I was back at school and music lessons unlike anything I ever had. Fancy creating a film of 9 and 10 year olds experimenting with pentatonic scales anyone? Or get 15 kids to learn to play recorder simultaneously via google classroom? It's all happening. I am simply the at-home-facilitator and provider of snacks, pencils, motivation and 'peace' when the tech goes wrong. A flavour for you:

10 year old hard at work on a live lesson with long division. I kid you not. Today was more creative for the 7 year old, as she has been working hard at Maths, English and French yesterday. So have I. So today I have made a Chinese dragon head from an Amazon box to celebrate Chinese New Year, and a shop to check how to give the right change. She has a class FaceTime and I get a swig of coffee. I see about lunch.

I had found an article from the Guardian's Felicity Cloake about how it was an art to make carbonara. Mine usually comes out as scrambled egg on spaghetti. The trick is apparently to coat the spaghetti with oil from the bacon. That oil was really burnt so I try olive oil and add a little cooking water. Then add the eggs. For the first time in 10 years I find it has worked, and exactly as the Maths lesson finishes for the 10 year old and the live numbers game finishes for the 7 year old. What timing. I am a genius. I have created a work of art. Parmesan and hey presto.

Oh, 7 minutes should be enough time for my husband to eat as it turns out he has a meeting from 1-4pm. To those in business - please STOP scheduling meetings at lunch time. It's not clever or kind. Give us all a break! It's bad for everyone. Then a glorious pause. Sylvanians upstairs, and I call the surgery who have left me a missed call. It takes 17 minutes to get through so I clear up lunch, listen to Radio 4 and finally get through. They don't know who called me, or whether it was about me or our children, both of whom have delayed hospital appointments and one has had blood tests this week. The eldest shrieks into the kitchen as I put the phone down. Why didn't you come and tell me? It's 1.45! It's Geography!

3pm I take photos and upload 6 pics of maths pages and photos of the morning's activities. 3.13pm

We don hats scarves and gloves and brave the fearsome cold outside as I have got a dust sheet and cracked open the bright green and red paint which I had bought with good intentions before Christmas. Phone down: focus on the dragon. We have a funny and peaceful time together learning about Chinese New Year. Who knew that the Christmas table cloth and hoola hoops can make for a dragon body, at least of sorts.

I check what work has been handed in or not by my 10 year old. Am asked for the password again in my phone despite having been using it all day for home school. I put in the one that has been used for a few weeks. It doesn't work. I try it and a few others until I am locked out. I set my youngest up on a maths game to help her understand number bonds and to help me clear my way to a revived password for the 10 year old. Enroute I clear up the modelling clay bits from yesterday which are in danger of forever penetrating

the carpet. Realise the chickens haven't been fed so run out to see them,- beautiful breath of fresh air and am warmly welcomed. Three minutes later I am asked to get the string bauble we had made, out of the oven. It hasn't caught fire and is apparently suitable for hanging from a tree sculpture now under construction by the 7 year old who has abandoned the number bonds.

I check on a menu for an Argentinian restaurant for Geography. We only have the first course. Devilled eggs; ok we can make those during half term. 4.25pm we need to prepare for the choir rehearsal at 5.30. It should all be filed but the reminder email tells me the name of the composer not the name of the piece, and I have carefully filed all pieces by their title. I go through the file with our eldest. Casals is missing. I spend 20 minutes searching for the document through emails by the keyword Casals. Nothing. By the title of the sender; nothing. I look through the list of previous assignments online. Nothing. Am reminded that we need to record two pieces by midnight tomorrow. I shall be drinking G and T tomorrow night. I check in the folder marked All Rehearsals; nothing. I check back through January. YES 28 Jan. It was a family birthday so I wasn't paying attention...we have it. They are being fabulously organised. I can't fault them. My organisation is just different. It is called O VOS OMNES. Indeed. I print out the relevant hymns which you do by opening another window and electing Print. Easy enough until prohibited by the printer, fiddle around with it and manage it. The notes have printed out small and dark. The words are just legible, ok if you are singing from them. Not so good if you are trying to look at the conductor and camera. I find the two hymns on Sonos sound system and put them on repeat loop for an hour.

The girls are persuaded to leave the comfort of the new den they have constructed in our sitting room. It looked so normal half an hour ago. If we clear up before we go out, we will have missed the last of the winter sunshine. Let's do it when we get back. Girls are harmonising in a most unharmonious way. But they are clearing up the sitting room. They charge through ready for an afternoon snack. Toast and peanut butter. The remains of the cake we made for said birthday really have had it and must go. It feels as though I have only just recovered from clearing up carbonara for lunch but at least we are ready for the choir rehearsal and thank God, truly, that we are all healthy.

The dragon is eying me. Maybe I will have that G and T tonight.

Quiz

*'Spring has Sprung', set by Chris @ Charlton All Saints
answers in e-N&N*

- | | |
|---|---|
| 1. What is the term for the first day of spring? | 6. In Vivaldi's Four Seasons, where does 'Spring' occur when played in order? |
| 2. What date does this fall on? | 7. Who painted the picture 'Primavera'? |
| 3. What is the name of the Roman goddess of spring? | 8. Which bike race is nicknamed 'La Primavera'? |
| 4. Which Jewish holiday coincides with Easter? | 9. In which US state is the city of Palm Springs? |
| 5. What date is St. Patrick's Day? | 10. In which Shakespeare play is the poem known as 'Spring' sung at the end? |

Church News

Britford Church

St Peter's Church in Britford remains open to everyone during daylight hours. Please do visit our lovely church (wrap up warmly!) We have a Lent Prayer Place on the tower crossing and you are very welcome to write a prayer and hang it on the Prayer Tree. All your prayers will be offered at our service of Parish Communion at 9.30am on 7 March. All the expected Covid safety procedures are in place and you will be very welcome.

In April, our Easter Service will be full of joy and I do hope you are able to join us – a rousing verse or two of 'Thine be the glory' will hopefully be sung outside! Meanwhile I do hope your Lent is both prayerful and meaningful and full of hope.

Reverend Canon Jenny Taylor

Odstock and Nunton Church

The Church Wardens of both village churches feel that holding 'in person' church services still represents a significant risk to all involved and so we would ask you to continue to follow either the Benefice weekly on-line service or whichever on-line or broadcast service that you enjoy. We are, however, pleased to invite the local community to a zoom meeting – Sundays at Six – a sociable meeting with prayers, worship, reflection and a time to chat. If you require further information about any of these on-line events, please contact Stephanie (stephanie.elcock@gmail.com)

In addition, we are happy to have both churches open for private prayer at different times during the week.

- St Mary's, Odstock will be open on Tuesdays and Fridays from 10am to 4pm,
- St Andrew's, Nunton will be open on Wednesdays and Sundays from 10am to 4pm.

The PCC has agreed that we will take as our guideline the date when pubs are allowed to open as the time when we will recommence 'in person' services in our churches.

Stephanie Elcock, Robert Underhill, Mary Boyd-Camp; Church Wardens

Charlton All Saints Church

The church will continue to remain closed for the time being. The situation will be kept under review. - *Ian Ashworth, Church Warden*

The Benefice Lent Project

Can you stand not sitting?

As we are unable to hold our usual Lent fund-raising events, we hope that you will support the Lent Project '**Can you stand not sitting?**' - and help to purchase chairs and desks for the church school in Cueibet, South Sudan. A Lent leaflet is being delivered with your N&N and you can see it in the e-version of N&N.

*The schedule of services in the Benefice can be found in the Benefice Bulletin.
email: thechalkevalleychurches@gmail.com for more details*

Please feel free to contact The Reverend Anna-Claar, with questions, answers, prayers or something else. Phone: 01722 238 267 or email: anna-claar.cvb@myphone.coop

Lent Project

Chalke Valley Benefice

LENT 2021

Wednesday 17th February - Saturday 3rd April

Can You Stand Not Sitting?



In 2017, the Chalke Valley villages delivered 40 bicycles to the people of Cueibet, South Sudan to get their pastors on the move. This year, we want your help to keep their children still!

John 15: 12

'My command is this: Love each other as I have loved you.'

In 2013, Canon David Henley first visited Cueibet. They said they needed a church primary school. Next year there were 4 classes with about 200 children taught in the shade of four large trees. Each week, they borrowed benches from the small cathedral.

Now the school has over 900 pupils taught in two sessions a day in three mud-brick classrooms funded by Chalke Deanery. But, benches are still carried in from the cathedral. Some older children have to bring in their own plastic chairs while younger ones sit on the mud floor.

Can we stand by while they can't sit? With your help, these children can have what ours take for granted. We want to give the school its own chairs and desks.

£6000 will fund

18 double desks

69 benches

Why not give

£120 for a desk

£55 for a bench

or £? for a leg?



Details of how to donate can be found
inside this leaflet

Lent Prayer Tree



As we are not able to gather for village events this Lent, each parish church has been asked to create a Prayer Place or Prayer Tree where you are invited to come and sit, reflect and pray.

It is hoped that each church will offer a Prayer Tree and you are asked to ...

- Write a short prayer at home
- Visit your local church this Lent
- Place a prayer on the Prayer Tree

Sit, reflect and share the prayer on the chair each week and know that others throughout the Benefice are praying with you.

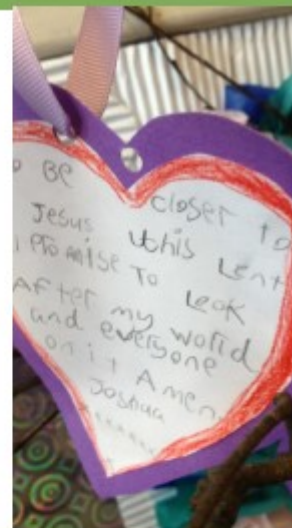

'Truly I tell you, whatever you did for one of the least of these brothers and sisters of mine, you did for me.'
Matthew 25:40



How to Give

We can't join together for our usual fundraising events, but there are still ways of giving:

-By online banking: **The Chalke-Cueibet Partnership Trust, Lloyds Bank,**
Sort Code: 30-90-89 Account Number: 75231860 giving your name as reference

-By cheque payable to **The Chalke-Cueibet Partnership Trust**
and sent to: CCPT, c/o 27 Viking Way, Salisbury SP2 8TA

For further details or if you would like a Gift Aid declaration form, please contact:

Geoff Taylor: ☎ 01722 503081 chalkecueibet@gmail.com

****If you are able to 'Gift Aid' your donation, please use the form on the back page****



MARK 10:13-16

'People were bringing little children to Jesus for him to place his hands on them, but the disciples rebuked them. When Jesus saw this, he was indignant. He said to them, "Let the little children come to me, and do not hinder them, for the kingdom of God belongs to such as these. Truly I tell you, anyone who will not receive the kingdom of God like a little child will never enter it." And he took the children in his arms, placed his hands on them and blessed them.'

WEEKLY LENT PRAYERS

Along with the prayer chairs in each church there will be:

- A weekly prayer sent with the Bulletin
- The Church of England daily prayer link
- We also hope to offer '**Prayers with Scripture and Silence**' sessions via Zoom. The group will be led by Revd Anna-Claar and meet every Tuesday starting on 23rd February 12 noon to 12.30 pm. If you are interested please email Emily at thechalkevalleychurches@gmail.com and you will be given details about how to join.



'HOPE IN THE FACE OF SUFFERING' A LENT STUDY GROUP

Do you struggle with faith and suffering?

Are you missing fellowship and discussing your faith with other Christians?

During Lent there is the opportunity to join a virtual study group, by Zoom, to look at one of the more taxing questions in Christian faith:

How can we have hope in the face of suffering?

The course will be based on the book by Jeremy Marshall titled "Hope in the face of suffering" (available from all good online book sellers) and will meet on Zoom every Wednesday evening in Lent (except Holy week) at 8.00 pm. The discussion will last about 45 mins and it is expected that participants will have read the designated passage for the week in advance as it takes only a couple of minutes.

If you would like to join for all, or just some of the sessions, please email Revd Roger Leake revrleake@gmail.com to receive the Zoom link and login details.

DAY OF PRAYER AND FASTING FOR OUR CITY



Sun 28th February
7.30-9pm on zoom

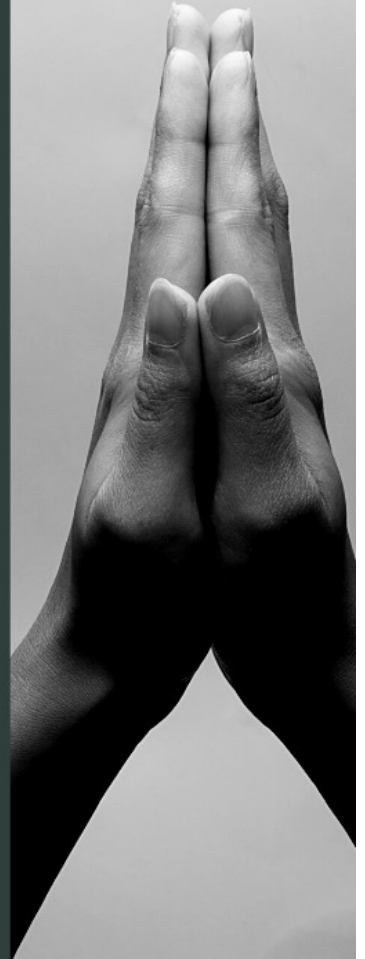

The plan will be to have a short time of **worship**, and then having **different people leading** us in prayer for different areas. We believe there will be **great power** in believers coming together in **unity** and **crying out to our Father** for breakthrough in our City.

Topic: Day of Prayer and Fasting for our City

Time: Feb 28, 2021 19:30 London

Join Zoom Meeting

<https://us02web.zoom.us/j/88520203054?pwd=bmhPUG9LMjRVM2hXRG95cDJNZmhlQT09>

Meeting ID: 885 2020 3054 Passcode: 423050

Subsumed and Submerged

Wiltshire Council Proposals for Britford

Wiltshire Council Local Plan Review

What are the proposals?

Wiltshire Council are undertaking a review of the Wiltshire Core Strategy 2016-2036, and the development of the Local Plan. They are proposing to allocate sites for development. Please have your say **by the CONSULTATION DEADLINE MARCH 9th, 2021.**

www.wiltshire.gov.uk/planning-policy-local-plan-review-consultation

Two of the three selected sites are:

Site 6 North of Downton Road

This is the field that separates the village of Britford from the edge of the city. The proposed allocation is for approximately **220 new homes**. It will include Cathedral Vista, a circa 40m wide sightline through the designed scheme to Salisbury's most celebrated landmark. Suggestions include **2000sq m of parking and an Early Years nursery and GP practice**. Dense (20m) woodland planting and allotments along Lower Road would provide the proposed division between the village and the city.

Site 7 South of Downton Road

The proposal is for approximately **115 new homes** above and around the Park and Ride. This is to include self-build, custom-build and open space including play provision, potentially in the form of **a Country Park**, enabling panoramic views across the city centre, the Cathedral and surrounding downland, as well as facilitating the significance and setting of the Ancient Woodbury Villages scheduled monument. The new quarter would integrate an existing quarry and associated woodland, new woodland and tree / hedgerow planting, walking and cycling links to Britford Park & Ride, Salisbury District Hospital, the city centre and wider countryside access.'

What if I do nothing?

The proposals would have devastating consequences for the whole village and the surrounding area. It is likely to cause wider drainage issues and traffic problems. The likelihood of the coalescence of Britford with the city is very real. Your knowledge and experience of Britford is invaluable, so PLEASE MAKE YOUR VIEWS KNOWN.

How do I respond?

Go to the link above and find the 'Planning for Salisbury' document. It has specific questions for us to answer to reply to this consultation productively and in a way which will inform Wiltshire Council's plans. The relevant maps are pp. 15-17.

Then write or email by 9th March:

spatialplanning@wiltshire.gov.uk

or post to **Spatial Planning, Economic Development and Planning, Wiltshire Council, County Hall, Trowbridge, BA14 8JQ.**

If you have no internet access, please contact the Spatial Planning officers on 0300 456 0100 for help with hard copies.

Comments received will help shape the draft Local Plan which will be prepared for consultation in late 2021.

So how can I respond most constructively?

With your knowledge and experience of Britford, please!

Britford Parish Council is concerned that there are issues in the 'Planning for Salisbury January 2021' document which when given their proper weight in the planning process will demonstrate that the Scale of Growth (p.3); the Place Shaping Priorities (p. 5); and hence the Concept Plan (p.9) produced by the Council in respect of Sites 6 and 7 are very badly flawed. This is not the appropriate way to develop them. Given the short time frame to formulate a response, if you would find it helpful to use some the concerns below to prompt or shape your own comments, please do:

'Scale of Growth'

Question SB1: What do you think of this scale of growth, should there be a brownfield target?

The scale of current planning growth is too much, too fast.

1. Wiltshire Council must pause and re-evaluate all plans considering the pandemic. Retail, home working and shopping habits have fundamentally changed, and the city centre has been decimated. They should be using the lower government target of 41,000 homes for Wiltshire and not adding another 5000 homes to their target.
2. **The impact of 600 houses which have had planning permission approved on the Netherhampton road has yet to be felt. Until those houses are being lived in, and all the effects evaluated particularly the increased traffic no additional development should not be contemplated.**
3. The Local Plan must increase targets for and prioritise building on brownfield sites. It is insufficient to say, 'as far as possible' on brownfield land. This must become a feature of growth plans.
4. The City Council must be empowered to do more than 'call for sites' in their work connected to the Salisbury Central Area Framework. This is an opportunity to give Salisbury the tools for the regeneration it needs to strengthen an impoverished city centre. Brownfield housing should be focused on the centre and with renewed vigour around the Railway station, and Churchfields Industrial Estate as an alternative to a valuable green field site.

'Place Shaping Priorities'

Question SB2 Are these the right priorities, what priorities might be missing, how might these place shaping priorities be achieved?

1. The priorities identified are almost right; but insufficiently aligned to essential wider requirements: each must be viewed explicitly in the light of increasingly wet weather, flood risks and achieving carbon reduction.
2. Additionally needed: **The effects of surface water flooding must be made a place shaping priority, together with a policy which maximise biodiversity and targets woodland creation for infiltration and carbon reduction purposes; and in iv) maintaining separation and conserving the distinctiveness of Britford.**

'Concept Plans'

Question SBSB3 Do you agree that these sites are the most appropriate upon which to build? If not, why not? What are the most important aspects to consider if these sites are to be built upon?

Concept map for Sites 6 and 7 showing boundary outlines and proposed layout and land uses, within which to accommodate development.

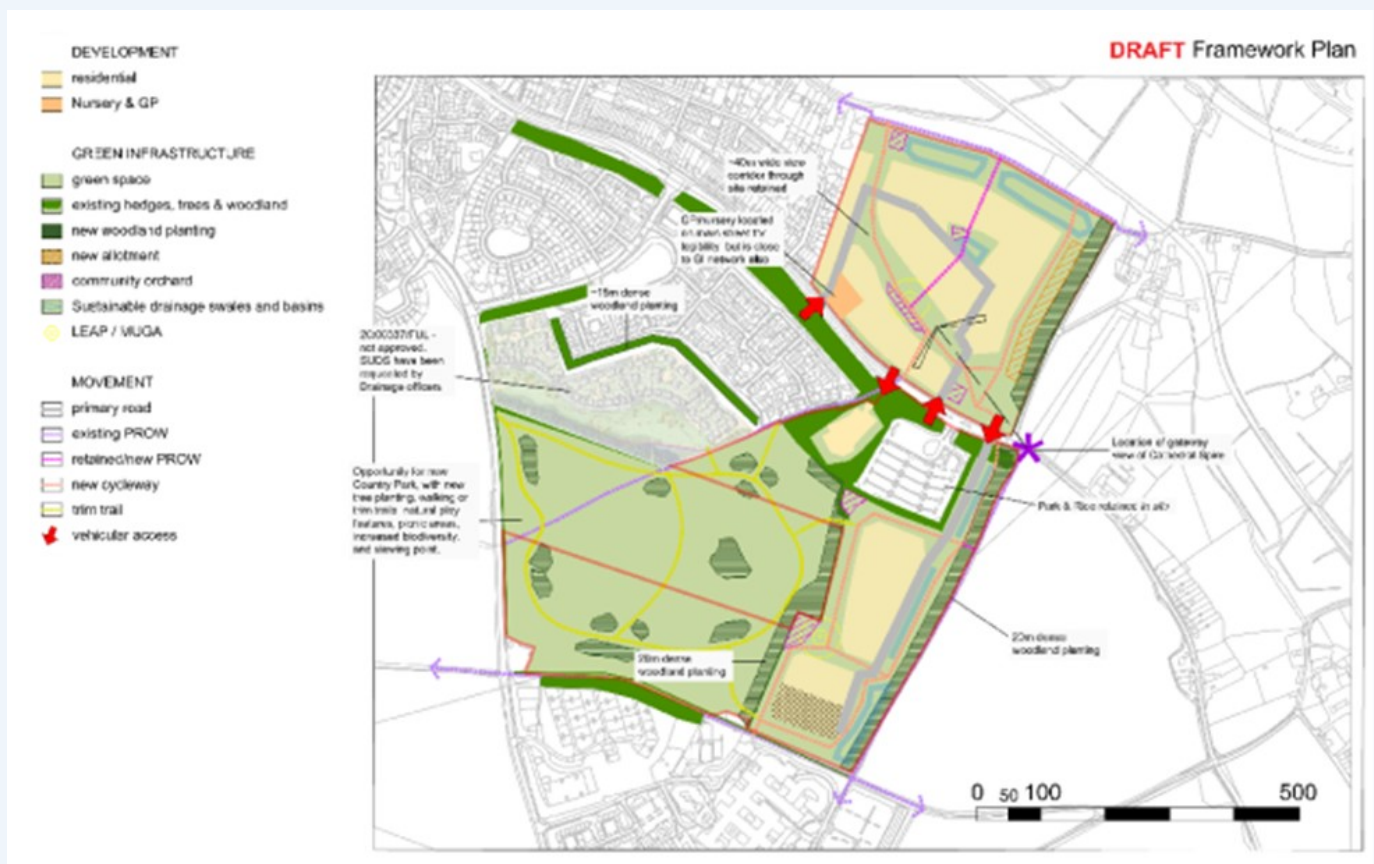

The Concept plans show one way in which Sites 6/7 could be developed. The consultation invites us to offer our own ideas too. We believe the current proposals for Sites 6 and 7 together are inappropriate for housing and undermine and are contrary to three key Place Shaping priorities:

1. **‘Conserving the Landscape setting of Salisbury, notably in terms of the city skyline and views to/from the cathedral...’:**

- i. The landscape setting of Salisbury will not be ‘conserved’ by these proposals.
- ii. Many walkers and joggers seek out and enjoying the unspoilt landscape setting. Britford is a Conservation Area with distinct character and sense of pastoral serenity, forming a wider setting to the city. This must be preserved.
- iii. A single 40m wide arc proposed for Site 6 to make the Cathedral visible from the road does not outweigh the manifest disadvantages of building houses on the rest of the site. The plans also negate any views from the road out of Salisbury down into Britford which currently serves to make the village a separate and distinctive community.

2. **‘(iv): Maintaining separation and distinctiveness between Salisbury and Wilton, and between Salisbury and adjacent settlements, notably Ford, Laverstock, Britford, Netherhampton and Quidhampton’ Maintaining separation and distinctiveness’:**

- i. The proposals have not taken into account the wider importance of Britford as a piece of our Wiltshire heritage. It is a small village, but it has a particularly attractive and diverse representation of vernacular architecture in a medieval setting against the water meadows the village with an historic church with Anglo Saxon origins and village green. It also has a school, hall, and farm shop. Its character needs protecting from urban development by more than a strip of plantation.
- ii. The development of Site 6 would lead to complete coalescence of the village of Britford with Salisbury itself and the village would be subsumed. There would be an irreversible detrimental effect on the historic landscape of the city and the Cathedral. Britford is presently separated from the city by a single large field. To reduce this to a 20m buffer would mean effective visual separation between the village and the city could no longer be achieved.

3. **‘ix Providing infrastructure for flood resilience’.**

- i. The Site Selection report for Salisbury concludes that 220 houses built on Site 6 would not be at risk of flooding (although 120 houses south of the Downton Road would certainly cause increased surface water run-off down the hill which makes this at the very least questionable). It completely fails to consider the complexities regarding Site 6 itself and the land immediately below and adjacent to it:
- ii. Site 6 is already a saturated field. The recent ploughing attests to this.
- iii. Recent developments have already shown how fragile is the relationship between the ground water and the housing in the village, sitting as it does right on the edge of the water meadows.
- iv. Heavy rain or storms already cause flash flooding along Lower Road and cause the Navigation to flood immediately and the levels of water in the water meadows to rise very rapidly. Work done to mitigate this wider risk when these developments took place has been insufficient despite assurances.
- v. Not only the immediate problems of run-off but the more invidious and less obvious problems of ground water levels in these low-lying meadowlands need to be remembered. If the Site 6 were to remain free of built development, it could lessen the impact of the development of Site 7 and the houses on the south side of the Downton road.

vi. Sewage infrastructure is also affected by ground water and surface water. Sewage disposal is a big concern. It appears that the Southampton Road plant is under considerable pressure and that is before the addition of the development at Netherhampton.

vii. To build over Site 6 which is next to the watermeadows and flood plain where the water table is already very high, would be to invite regular, polluted flooding. Surface water flooding is a real and increasing threat to life, to property and to the economy. The proposed swales and basins to absorb water at the base of the Site 6 would be hopelessly inadequate.

Further Aspects to Consider:

The constraints of Site 6 outweigh the benefits of building on it.

Britford Parish Council accept that the Council would argue that if a compromise must be reached and the concept plan reconsidered. The Country Park should be positioned onto Site 6. That will have the advantage of-

- Preserving the historic landscape
- Reducing the risk of flooding
- Creating a gap between the village of Britford and the city of Salisbury that would be properly defensible in the long term and would preserve the amenity of the village and the existing homes on the edge of the city.
- Reducing the risk of flooding and adverse effects on the water meadows
- Providing an open space easily accessible to the inhabitants of Salisbury as well as the residents of new homes.
- and the re-development of the centre of Salisbury must be the priority over Sites 6 and 7.

Finally

There is no need to include every one of these points in your letter, although feel free to do so.

The important thing is to get your views sent in! It is vital that the community respond to the Council's proposals.

This is an ongoing consultation and if you would like to be kept informed of its progress please email clerk@britfordparishcouncil.co.uk

Light Relief

A long time ago, two sisters, one blonde and one brunette, inherit the family ranch. Unfortunately, after just a few years, they are in financial trouble. In order to keep the bank from re-possessing the ranch they need to purchase a bull from a stockyard in a far-away town so that they can breed their own stock. They only have \$600 left.

Upon leaving, the brunette tells her sister, "When I get there, if I decide to buy the bull, I'll contact you to drive out after me and haul it home."

The brunette arrives at the stockyard, inspects the bull, and decides she wants to buy it. The man tells her that he will sell it for \$599, no less. After paying him, she drives to the nearest town to send her sister a telegram to tell her the news.

She walks into the telegraph office, and says, "I want to send a telegram to my sister telling her that I've bought a bull for our ranch. I need her to hitch the trailer to our pickup truck and drive out here so we can haul it home."

The telegraph operator explains that he'll be glad to help her, then adds, "It's just 99 cents a word." Well, after paying for the bull, the brunette only has \$1 left. She realizes that she'll only be able to send her sister one word. After a few minutes of thinking, she nods and says, "I want you to send her the word 'comfortable.'"

The operator shakes his head. "How is she ever going to know that you want her to hitch the trailer to your pickup truck and drive out here to haul that bull back to your ranch if you send her just the word 'comfortable?'"

The brunette explains, "My sister's blonde. The word's big.

She'll read it very slowly..... com-for-da-bull."

Two things to make your day better:

- Do not watch the news.
- Stay off the bathroom scales.



Don't forget that this month we are celebrating those three days when men are always right - 29th, 30th and 31st February!

www.silversurfers.com

Quotes

Oscar Wilde

Born Oscar Fingal O'Flahertie, on 16th October 1854, he died on 30th November 30, 1900. His mother Jane was a poet, while his father, Sir William Wilde, was prominent Irish surgeon. Both parents were prolific authors so it was no surprise that he inherited such literary talent. One can only guess how he delivered his quips, but we can be sure that they gained extra power from Oscar Wilde's own delivery of his pithy wit.

Here is a selection of Oscar Wilde Quotations.

- ◇ *My own business always bores me to death; I prefer other people's.*
- ◇ *The English country gentleman galloping after a fox - The unspeakable in full pursuit of the uneatable.*
- ◇ *Only dull people are brilliant at breakfast.*
- ◇ *We have really everything in common with America nowadays except, of course, language.*
- ◇ *There is no such thing as a moral or an immoral book. Books are well written or badly written.*
- ◇ *But what is the difference between literature and journalism? Journalism is unreadable and literature is not read. That is all.*
- ◇ *America is the only country that went from barbarism to decadence without civilization in between.*
- ◇ *Anyone who lives within their means suffers from a lack of imagination.*
- ◇ *It is absurd to divide people into good and bad. People are either charming or tedious.*
- ◇ *Arguments are to be avoided: they are always vulgar and often convincing.*
- ◇ *Seriousness is the only refuge of the shallow.*
- ◇ *Who, being loved, is poor?*
- ◇ *I always pass on good advice. It is the only thing to do with it. It is never of any use to oneself.*

Purveyors of Fine Fresh Food

Here are a few links to local companies providing food during lockdown



Stable & Wick

A new bakery and farm shop in Wick Farm, Wick Lane, Downton.

Open Tuesday - Saturday 10am - 4pm.

Visit their website StableandWick.com

THE *Horse*
&
Groom

We will be continuing to offer takeaways, for collection or delivery.

Take a look at our [Takeaway Menu here](#).

If you would like to place an order, please give us a ring on 01725 510 739

or contact us via our [Facebook Page](#).

BREAD
FLOWERS
AT HOME

YOUR BREAD & FLOWERS RESTAURANT AT HOME

Freshly cooked meals designed for a weekend treat, Everything is cooked & prepared to order at our HQ

Dishes are cooked freshly each week, to be reheated at home

"I was going to say "restaurant quality" but few restaurants could send that out. Really exceptional – just superb".

Visit their website:

breadandflowersathome.co.uk

Home baking?



You'd better come and see us, a great flower flour selection when you yeast expect it, for not a lot of dough. Don't delay, you knead to use your loaf and visit us today!

ALSO, DON'T FORGET:

- Contact-free delivery service
- Free delivery within 5 miles of Coombe Bissett
- Low £20 minimum order for free delivery
- No fighting for delivery slots!
- Collect during opening hours if you prefer
- Mail orders to shop@coombebissettstores.co.uk OR CALL US on 01722 781852

01722 718852

Coombe Bissett Stores • Homington Road
Coombe Bissett SP5 4LR

Shop and Post Office hours
Monday to Friday 7.00 am – 6.00 pm
Saturday 7.00 am – 1.00 pm

Closed Sundays and Bank Holiday Mondays



Adverts



PURE HEALTH
FITNESS & THERAPIES

PERSONAL TRAINING
1:1, Group training,
Weight loss, Weight gain, Functional
movement patterns & Rehabilitation

THERAPIES
Sports Injuries & rehabilitation, Sports, Deep
Tissue, Hot stone Massage, Physiotherapy,
Chinese Acupuncture & Tui na

FITNESS CLASSES
With highly qualified instructors,
also offering 1:1 sessions on demand

STUDIO & TREATMENT HIRE
A Beautiful, rural setting for therapists and
instructors needing a venue
For more information on Pure Health, its
Trainers, Therapists and class timetable, please
go to [www. PureHealthOdstock.co.uk](http://www.PureHealthOdstock.co.uk)

 Find us on
facebook

If any local advertisers would like to advertise on these pages with a longer advert, description of their services or just add a colour advert, then please contact the Editor.

Save the Date

There is a great hope that we will be able to have a village event of some kind on Saturday 3 July and Sunday 4 July.

More details next month

UNIQUE RESIDENCE WITH MOBILE POTENTIAL

Offer in region of £000,000

For small agents and smaller occupants.

Unfurnished comprising 2 beds, 2 reception, kitchen, hall and stairway.



Base 83 x 50 cm; Height including chimney 88cm.

Mid 20th Century, from a Church Hall in Downton, unoccupied for 20 years, the house is in need of restoration - perhaps a lockdown project for an enthusiast in miniature buildings.

The house is destined for the bonfire if not adopted.

Contact Hatty Hillier on 01722 324788



DESIGNED TO BE A WEEKEND TREAT

Bread and Flowers brings you dynamic, heady flavours that galvanise and inspire.

Dishes are cooked and prepared to order at our HQ. Ready to be collected by you and reheated at home.

ORDER YOUR TAKEAWAY ONLINE FOR COLLECTION ON FRIDAY 2-6PM

Our Friday menu features

- **mezze / starters**
- **main courses**
- **side dishes**
- **puddings**
- **food for entertaining**

enquiries@breadandflowers.co.uk

01722 326581

Bread and Flowers
Longford Farmhouse

Bodenham, Salisbury, SP5 4EJ

breadandflowersathome.co.uk



Coombe Bissett Stores

**- the story so far, by Charles May:
owner**

I have been asked by the Editor to write a brief overview of Coombe Bissett Stores, which will hopefully give you a few insights of where we came from, what we do and perhaps where we're going.

After working at Ringwood Brewery, back in 2000 I had just come back from a year driving overland to Australia (that story will have to wait until another day) and was walking around Salisbury looking for a job. Oddbins were advertising for a delivery driver, and it turned out to be perfect for me. I was able to engage directly with customers, both in the shop and while delivering, offer high standards of customer service, lots of learning about the wines, spirits and other products, and, most importantly, regular tasting sessions! However, with a set list of products we had to turn away customers who were looking for something a bit out of the ordinary, and we were unable to offer beers from any of the excellent local craft breweries, which as a real ale drinker and enthusiast I found very frustrating.

In 2003 I'd decided that I wanted to have my own business and the idea of a specialist beer shop and grocer was born. In September 2003 I opened Abbey Stores in Salt Lane Salisbury. We soon found ourselves busy with a wide range of specialist real ales and other beers (around 100 at any one time), draught cider, a range of interesting spirits and a selection of fine foods and gifts. We also sold sandwiches, groceries, milk and were probably one of the first shops to offer Ecover refills. We were a village shop in the centre of the city, trying hard not to be just another convenience store.

We were interested in expanding into a second shop, and our search was still on when one of our existing customers came in one Monday morning and after a brief chat, he explained that the village shop in Coombe Bissett would soon come on the market and would we be interested in running the business?

It didn't take long to decide that this was the perfect opportunity, it was an established business, close, but not too close to Salisbury and with parking. With the existing owner retiring the building had been purchased by a consortium of villagers who were determined not to lose their local shop. They had decided not to run it themselves as a "community shop" with volunteers and a paid manager, so in January 2008 I became the proud owner of Coombe Bissett Stores. A full internal refurbishment brought the interior up to



date and I installed new refrigeration and computerised tills. The Post Office was also transferred onto the shop counter, meaning that any member of staff can work on either shop transactions or at the Post Office, occasionally at the same time!

Over the years we have built up the business and increased the stock lines and variety of products sold.

The original Abbey Stores closed in 2011 when the lease on that building ran out.

In 2014 the shop was threatened with being flooded when groundwater rose to unprecedented levels all around us; thankfully, unlike several other properties close by, we were not flooded. The continuing challenge is from the inevitable rise of the supermarkets, who seem to be determined to suck the lifeblood out of the surrounding areas with their huge out of town megastores and home shopping delivery vans.

We have always offered a free delivery service in Coombe Bissett, nearby villages and Salisbury itself. We continue to diversify our offering, covering all the essentials such as bread, milk, cereal, eggs and the like alongside more interesting foods and products that cannot be found so easily elsewhere or in the supermarkets. I think that a village shop should offer a bit of everything from the ordinary to the exciting and we try extremely hard to keep that in mind when sourcing new products.

When Covid came along last year all these elements came together when suddenly the supermarkets couldn't cope with the demands being placed on them from all directions. We were able to assist by ramping up our customer home deliveries, bringing in extra stock from new suppliers, dealing with orders for collection, coping with the extra mail volumes through the Post Office and, most importantly, keeping an eye on some of our more vulnerable customers in the community. I must pay tribute to my wonderful team: Alice, Bruce, Carol, Mary, Reece and Sam, who are the backbone of the business. Thank you all, it is a pleasure to work with you.

It is gratifying to see that many of our older customers are now receiving their first or even second vaccinations, a light on the horizon for all those struggling during this very tough time.

If you would like to see for yourself what we are all about, please visit in person or request a home delivery or collection order and we will do our best to help.

Coombe Bissett Stores and Post Office is open Monday to Friday 7am to 6pm and Saturday 7am to 1pm. Please email collection or delivery requests to shop@coombebissettstores.co.uk or phone 01722 718852. We look forward to hearing from you.

Quiz Answers

'Spring has Sprung'

1.	What is the term for the first day of spring?	The vernal equinox
2.	What date does this fall on?	21st March
3.	What is the name of the Roman goddess of spring?	Flora
4.	Which Jewish holiday coincides with Easter?	Passover
5.	What date is St. Patrick's Day?	17th March
6.	In Vivaldi's Four Seasons, where does 'Spring' occur when played in order?	First
7.	Who painted the picture 'Primavera'?	Sandro Botticelli
8.	Which bike race is nicknamed 'La Primavera'?	Milan to San Remo
9.	In which US state is the city of Palm Springs?	California
10.	In which Shakespeare play is the poem known as 'Spring' sung at the end?	Love's Labour's Lost

With thanks to our Quiz setter - Chris Clark of Charlton All Saints for all her hard work in researching these puzzles. One day we will be able to meet for the Village Quiz and Downton Fish & Chips!

And finally .. a Public Notice

Public Notice Burial Plot Reservation - Nunton

Due to lockdown, the Chancellor of the Salisbury Diocese has asked that the following notice be published.

Form 4a
(Rule 6.2)

PUBLIC NOTICE

In the Consistory Court of the Diocese of Salisbury

Church of: Nunton, St Andrew

In the Parish of: Odstock with Nunton and Bodenham

NOTICE IS GIVEN that we are applying to the Consistory Court of the diocese for permission to carry out the following:

The appropriation in the churchyard of the Parish Church of Nunton, St Andrew of a double-depth burial plot measuring 1 metre x 2 metres or thereabouts, the space being number 2 in row P as shown edged in RED on the plan attached to the petition.

A copy of the plan showing the space to be reserved is displayed with this notice.

Petitioners:

- 1 Robert Underhill
- 2 Deborah Underhill

Date 23/02/2021
(Enter the date on which this notice was first displayed.)

If you wish to object to this proposal you should send a letter stating the ground of your objection to:

The Diocesan Registrar at Minster Chambers, 42 Castle Street, Salisbury SP1 3TX

so that your letter reaches the Diocesan Registrar not later than 23/03/2021
(Enter a date 28 days after the date given above)

A letter of objection must include your name and address and state whether you live in the parish and/or your name is entered on the church electoral roll of the parish or any other capacity in which you object.

Please note: all correspondence received on this matter will be copied to the petitioners and sent to the Chancellor.
Objections cannot be made anonymously.



PLAN TO SHOW ROWS O and P - BURIAL PLOTS

NOT TO SCALE

FEB 2021

St. ANDREW'S CHURCHYARD NUNTON - SPS 4HP

PLOTS in x 2m

PATH

Row P

Row O

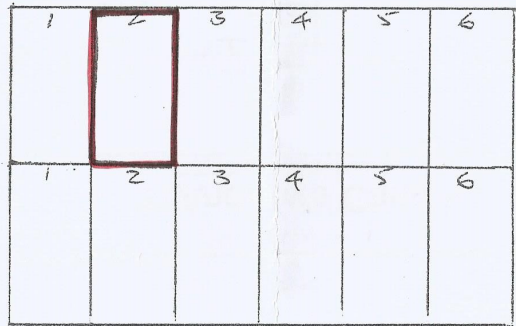

* OLD HEADSTONE
? John Woodford

BARKER

ROOM

YARD

R.W. UNDERHILL
CHURCH WARDEN

NATIONAL
MAP CENTRE

Supplied by: National Map Centre Herts
Licence number: 100031981
Produced: 29/07/15
Serial number: 1545683

OS Plan B&W

Plot centre co-ordinates: 415945, 126018
Download file: Print52610_154568
Project name: underhill_standrews

Scale 1:500

PLAN OF St. ANDREW'S CHURCHYARD - NUNTON
TO SHOW LOCATION OF ROWS O & P - HEADSTONES

FEB 2021



R.W. UNDERHILL
CHURCH WARDEN

The End!!